

## UL-Listed Hospital TVs

The LT662M Hospital TV provides advanced technology in a cost-effective solution designed for patients and staff. All features, including Pillow Speaker support and Hospital UL Certification, are designed for patient-oriented care, meeting the specific needs of individuals.



UL Hospital Grade Listed



Reliable Nurse Call System



Pillow Speaker Ready



Pro:Centric  
Information Management Solution





## Pillow Speaker Ready

Sound and videos can be controlled directly by a pillow speaker for patient convenience.

## Reliable Nurse Call System

Improve patient care and staff response with the reliable nurse call system by a pillow speaker.

## UL Hospital Grade Listed

LT662M is designed for the healthcare and hospital environment to withstand heavy use.



### Pro:Centric Information Management Solution

Pro:Centric SMART is optimized for customizing information and entertainment services through an IP & RF infrastructure. With its high picture quality, sophisticated design and advanced connectivity functions, the LT662M improves and creates new in-room experiences for patients, family and hospital staff.

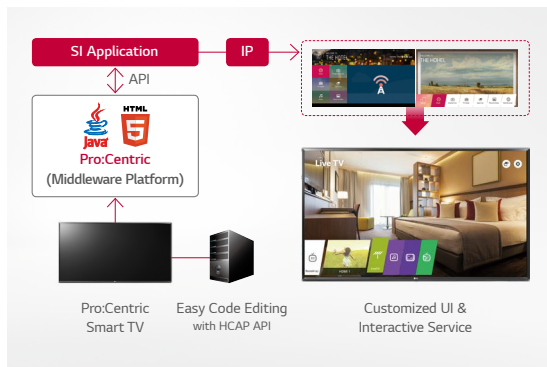

\* Customized UI may be little different.

### Pro:Centric Direct Solution

Pro:Centric Direct is a hospitality content management system that supports simple editing tools and provides various solutions such as 1-click service and IP-network-based remote management. With these solutions, users can easily edit the user interface, provide customized service and manage all TVs efficiently. PCD version 3.0 offers IoT-based in-room & voice control through LG Embedded Natural Language Processing (NLP). These features will prepare hospitalities for the enhanced future by AI.

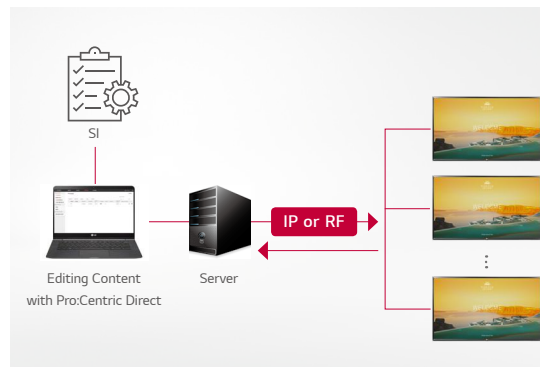

\* Actual UI may differ

\* When PCS400R and PCD 2.0 are used, PCD feature is available even in RF infrastructure. However, to have interactive services in RF infrastructure, Wi-Fi is required (RF+Wireless Infrastructure is needed).

### Pro:Idiom

We securely provide entertainment content with Pro:Idiom DRM(Digital Right Management) which prevents illegal copying on your LG devices



## Voice Recognition

From seamless interaction to consistent user experience, LG is going one step further to lead the commercial TV market by voice recognition, allowing users to easily control LG TVs. Our stable and dependable solutions based on webOS and Pro:Centric Direct will significantly enhance the competitiveness of your products and services, helping you achieve a successful business.



- \* TV Smart Control
- \* Server Based control
- \* Magic Motion Remote is required (sold separately)

## Soft AP

Software-enabled Access Point (SoftAP) is a "virtual" Wi-Fi that uses software to create a wireless hotspot. The current version supports Bridge Mode, which enables network managers to control connected devices.

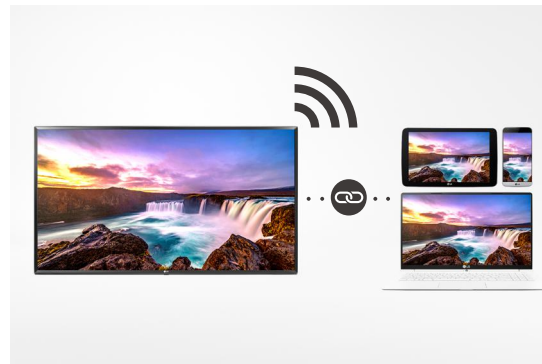

- \* SoftAP should be set in installation menu after TV is on.
- \* Smart Mirroring may not operate at the same time.

## Multi IR

Multi IR function eliminates the signal interference of remote controls that occurs between TVs in multiple rooms. This system also works on the same LG TV model.

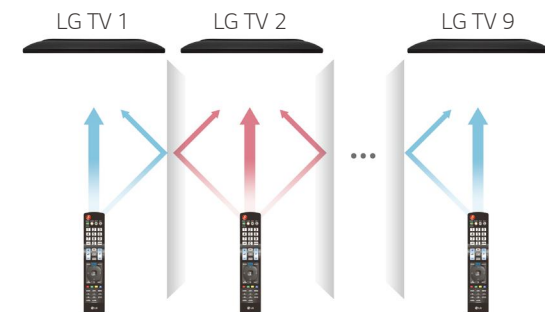

### Instant On

The high speed loading system enables users to enjoy content immediately after turning on the TV.



### EzManager(Express script)

EzManager provides a convenient installation function to automatically choose settings for the Pro:Centric TV without any extra configuration. And Express Script provides streamlined configuration of the TV for Free-To-Guest(FTG) Mode via CPU operation (including pillow speaker setup) and also provides the option to configure the TV for Pro:Centric operation.



### USB Cloning

USB data cloning makes managing multiple displays more efficient for optimal operation. Instead of setting up each display one by one, data can be copied to a USB for one display, and be sent to the other displays through a USB plug-in.

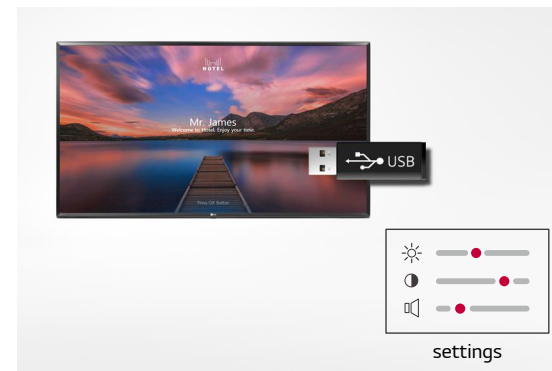

32"

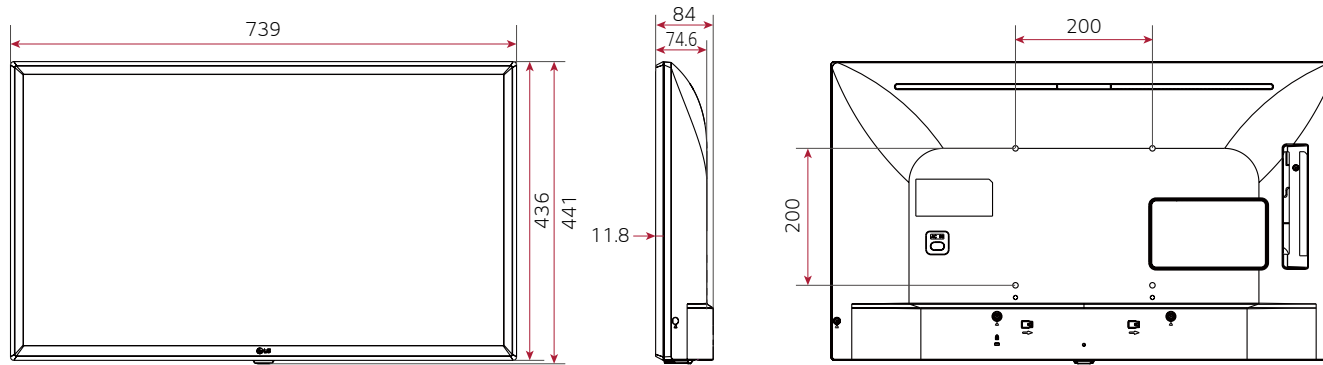

CONNECTIVITY

32"

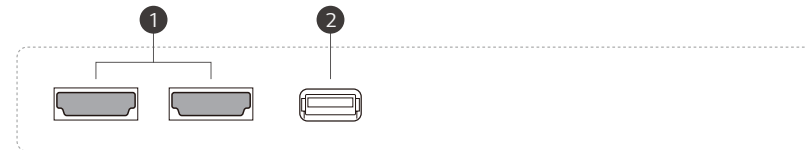
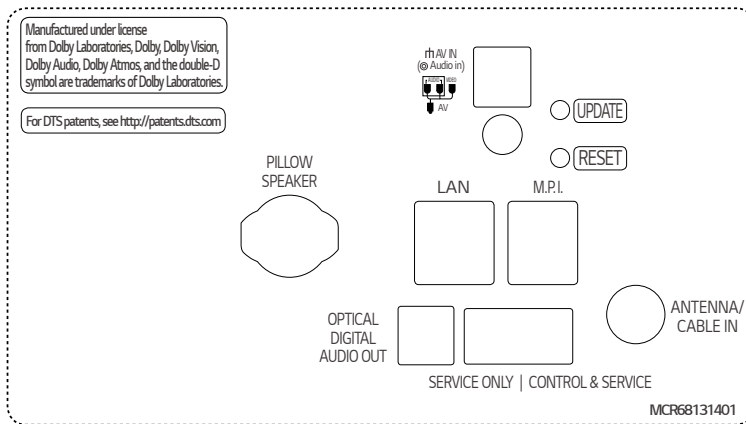

- ① HDMI IN
- ② USB IN

\* Dimensions & Jack Panels (Read/Side) may differ from the above image, so please contact LG sales team to verify before ordering.

# SPECIFICATION

LT662M (NA)		32LT662M (NA)
DESIGN	Stand Type	Without stand
	Front Color	Ceramic Black
DISPLAY	Inch	32
	Resolution	1,366 x 768 (HD)
	Backlight Unit Type	Direct
	Brightness (cd/m2)	240
BROADCASTING SYSTEM	TV Reception	ATSC / Clear QAM/VSBS, Analog NTSC
VIDEO	HDR (Dolby Vision / 10 Pro / HLG)	No / No/ No
AUDIO	Audio Output	5W + 5W
	Speaker System	2.0 ch
	DOLBY ATMOS	No
	DTS VirtualX	No
HOSPITALITY SOLUTION	Solution Type	Pro:Centric (Smart, V, Direct), Quick Menu 3.0
	Data Streaming ( IP & RF )	Yes
	HCAP (GEM / FLASH / HTML) * Service Carousel (TLL / XML)	GEM / HTML5
	IP Return path	Yes
	Multicast / Unicast ready	Yes / Yes
	webRTC (Real Time Communication)	Yes
	Pro:Centric Application (version)	PCA3.8
	Pro:Centric Server	PCS400R
DRM	Pro:diom (S/W Type), Pro:diom Media	
SMART FEATURE	webOS 4.5, Smart Home (Launcher Bar), Web Browser, Pre-loaded App, SDP Server compatibility, Magic Remote Compatibility, Clock (World Clock / Alarm), Soft AP, Wi-Fi (802.11ac, Built-in type), Screen Share (Miracast), Smart Share (DLNA), DIAL, Bluetooth Audio Playback, LG Sound Sync / Bluetooth, Mobile Connection Overlay, Voice Recognition (Standalone / Solution), IoT, EzManager (Express script), USB Cloning, Wake of RF, Wake on LAN, SNMP, Diagnostics (IP Remote), SI Compatible (MPI, RS232C), HTNG-CEC (1.4), Simplink (HDMI-CEC, 1.4), IR Out (MPI Jack / RS232C), Multi IR Code	
HOSPITALITY FEATURE	PDM(Installer Menu), Welcome Screen (Splash Image), Insert Image, One Channel Map, Instant ON, V-Lan Tag, RJP (Remote Jack Pack) Compatibility, USB Auto playback, Auto Off / Sleep Timer, Motion Eye Care, Required Approval (UL), Pillow Speaker, Anti-theft System (Kensington Lock)	
JACK INTERFACE	Set Side	HDMI In 2.0(2), USB 2.0
	Set Rear	RF In(tuner), AV In(Phone Jack Type), Digital Audio Out (Optical), RS-232C (Phone jack type), RJ45 (Ethernet), MPI Port(RJ12 jack), Debug (Phone Jack Type, CPU/PTC), Pillow Speaker interface (6pin)
DIMENSION (UNIT : mm / kg)	Vesa	200 x 200
	W x H x D / Weight (with stand)	-
	W x H x D / Weight (without stand)	739 x 441 x 74.6 (84) / 4.85
	W x H x D / Weight (Shipping)	812 x 510 x 142 / 6.05
POWER (UNIT : WATTS)	Power Supply (Voltage, Hz)	AC 120 V ~ 50 / 60 Hz
	Typical	26W
	Stand-by	Under 0.5W

\* Specifications are subject to change without notice, so please contact LG sales team to verify before ordering.



Download  
LG C-Display+  
Mobile App  
Google Play Store

- [www.lg.com/b2b](http://www.lg.com/b2b)
- [www.youtube.com/c/LGCommercialDisplay](http://www.youtube.com/c/LGCommercialDisplay)
- [www.facebook.com/LGInformationDisplay](http://www.facebook.com/LGInformationDisplay)
- [www.linkedin.com/company/LGInformationDisplay](http://www.linkedin.com/company/LGInformationDisplay)

LG may make changes to specifications and product descriptions without notice.  
Copyright © 2019 LG Electronics Inc. All rights reserved. "LG Life's Good" is a registered trademark of LG Corp.  
The names of products and brands mentioned here may be the trademarks of their respective owners.

